

11.1 Ordering Parts

For your convenience, replacement parts and accessories can be ordered from ARPAC® by fax 24 hours a day. Please have the following information available to ensure quick, easy, and accurate service.

- Your name and telephone number
- Your P.O. (Purchase Order) number
- Your preferred method of delivery

11.1.1 Replacement Parts Policy & Contact Information



PACKAGING

888-922-1622 WWW.IPACK.COM

11.2 How to Use This Parts List

11.2.1 General Part Numbers

This chapter contains all part numbers necessary to order Pro Series LPC replacement parts and assemblies.

This illustrated parts breakdown is presented in disassembled order. Detail parts are shown below their respective upper level assemblies whenever possible.

The parts lists follow the illustration for a particular assembly and represent components of that assembly. The number listed in the quantity column is the number of the specific part required to complete the assembly and may not reflect the quantity needed for the entire system.

The lists are divided into four columns. The item/index numbers refer to the identification number located on the drawing. The part number is the Arpac part number, used to identify the part for ordering. The part description column lists each part name, and the quantity column lists the quantity of that part used in that particular assembly.

Illustrations are shown before the parts list for each assembly.

11.3 Commonly Ordered Parts

| Part Description | Part number |
|--|-------------|
| Drive, DC, 1/4-1 H.P. 90VDC | 804012.190 |
| Drive, Regenerative 1/4-1H.P. | 804012.182 |
| Magnet, Rectangular Pressure Sensitive Adhesive | 822976. |
| Fuse, Glass AGC 8 Amp/250VAC | 804998.231 |
| Fuse-Glass AGC 2 Amp/250VAC | 803998.226 |
| Fuse-Glass AGC 10 Amp/250VAC | 803998.233 |
| Link, Connecting, #40 | 800502. |
| Link, Connecting, Offset #40 | 800523. |
| Link, Connecting, #50 | 800505. |
| Link, Connecting, Offset #50 | 800522. |
| Caster Wheel Assembly | 205114.000A |
| Pro-Series LPC Installation, Operation & Service Manual | 100003.284 |
| Spare Parts Kit - Wrap & Weigh | 237442 |
| Consists of: | |
| Base to Tower Cable Assembly | 237441 |
| Connector, 10P, Insert Female 16A | 825005.057 |
| Connector, 10P, Base, Panel Mount, Single Lock | 825005.053 |
| Grommet, 1" Hole, Rubber | 825012 |
| Load Cell, 4K, Pennsylvania Scale | 804998.503 |
| Trim Board - Pennsylvania Scale | 821096 |
| Scale, Digital Readout - Pennsylvania Scale | 821093 |
| Connector, Strain Relief | 804994.912 |
| Spare Parts Kit - Fuses | 206456 |
| Consists of: | |
| 5 Fuses, 2 AMP/250VAC | 804998.226 |
| 5 Fuses, 8 AMP/250VAC | 804998.231 |
| 1 Magnet, Round With Pressure Sensitive Adhesive Backing | 822977 |

Table 11-1: Commonly Ordered Parts

11.4 Overall Assembly

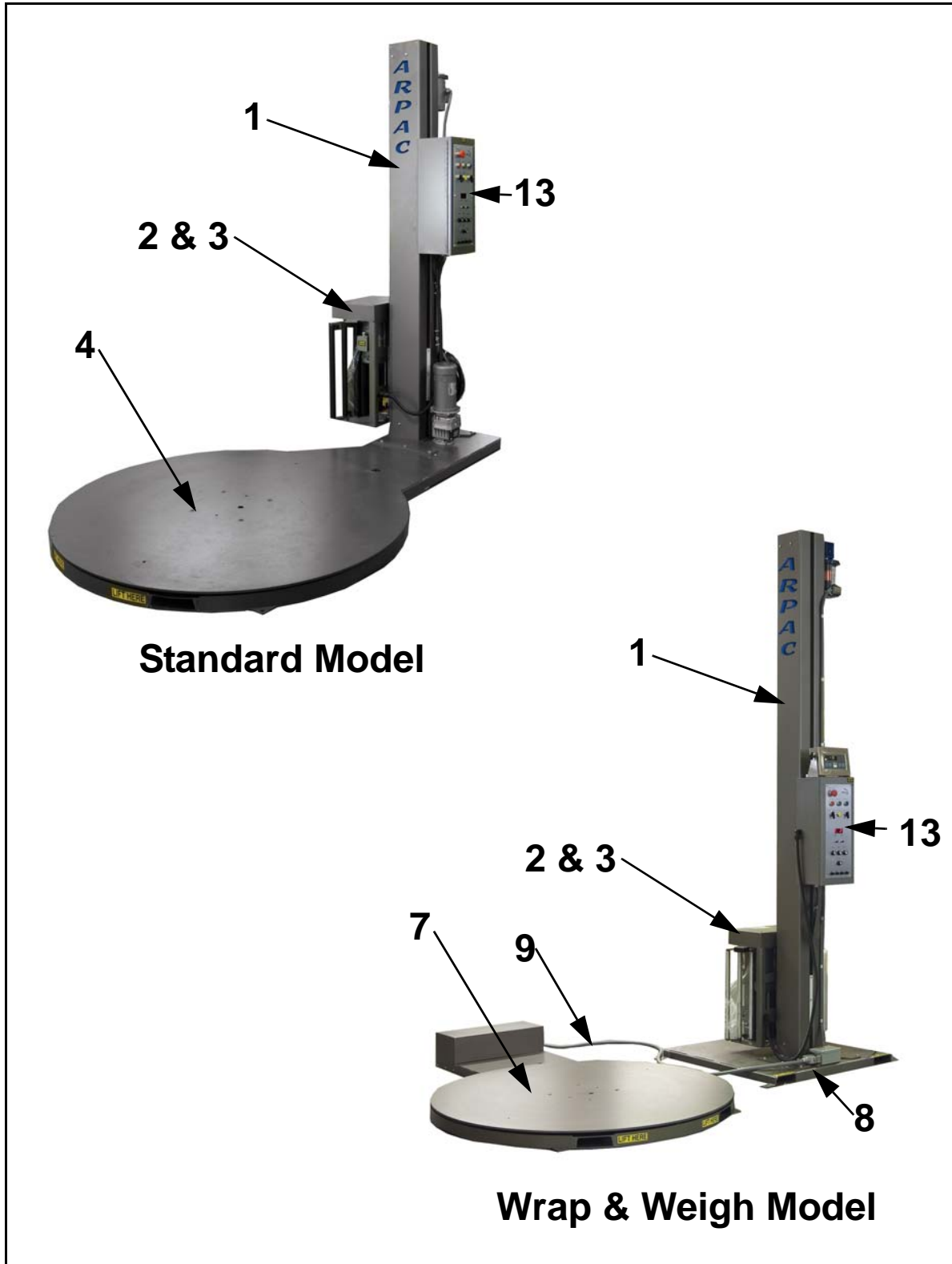

Figure 11-1. Overall Assembly

| Fig ref. | Part number | Description | Qty |
|----------|-------------|---|-----|
| 1 | 229987.000A | Top Drive Tower Assembly (See Section "11.5 Top Drive Tower Assembly" on page 11-6 for breakdown of assembly) | 1 |
| 2 | 224855.000C | Side Mounted Film Saver Assembly (See Section "11.6 Side Mounted Film Saver Assembly" on page 11-8 for breakdown of assembly) | 1 |
| 3 | 256956 | Swift Change Film Roll Support Assembly (See Section "11.7 Swift Change Film Support Roll Assembly" on page 11-11 for breakdown of assembly) | 1 |
| 4 | 252949 | Base Assembly (See Section "11.8 Base Assembly (4000lb Capacity, 59.5" Dia)" on page 11-12 for breakdown of assembly) | 1 |
| 5 | 221410 | Parts Kit, 200% Stretch, Film Saver | 1 |
| 6 | 235230 | Kit, Paint, Steel It, Semi-Auto | 1 |
| 7 | 252047 | Base Assembly - Wrap & Weigh Option (See Section "11.9 Base Assembly - Wrap & Weigh Option" on page 11-14 for breakdown of assembly) | 1 |
| 8 | 237633 | Tower Base Assembly - Wrap & Weigh Option (See Section "11.10 Tower Base Assembly - Wrap & Weigh" on page 11-16 for breakdown of assembly) | 1 |
| 9 | 237441 | Cable Assembly, 8ft | 1 |
| 12 | 206456 | Kit, Fuse, SW Pro-Series | 1 |
| 13 | 241645 | Pro-Series Control Assembly (See Section "11.11 Control Assembly (Part 1)" on page 11-18 and Section "11.12 Control Assembly (Part 2)" on page 11-20 for breakdown of assemblies) | 1 |

Table 11-2: Overall Assembly

11.5 Top Drive Tower Assembly

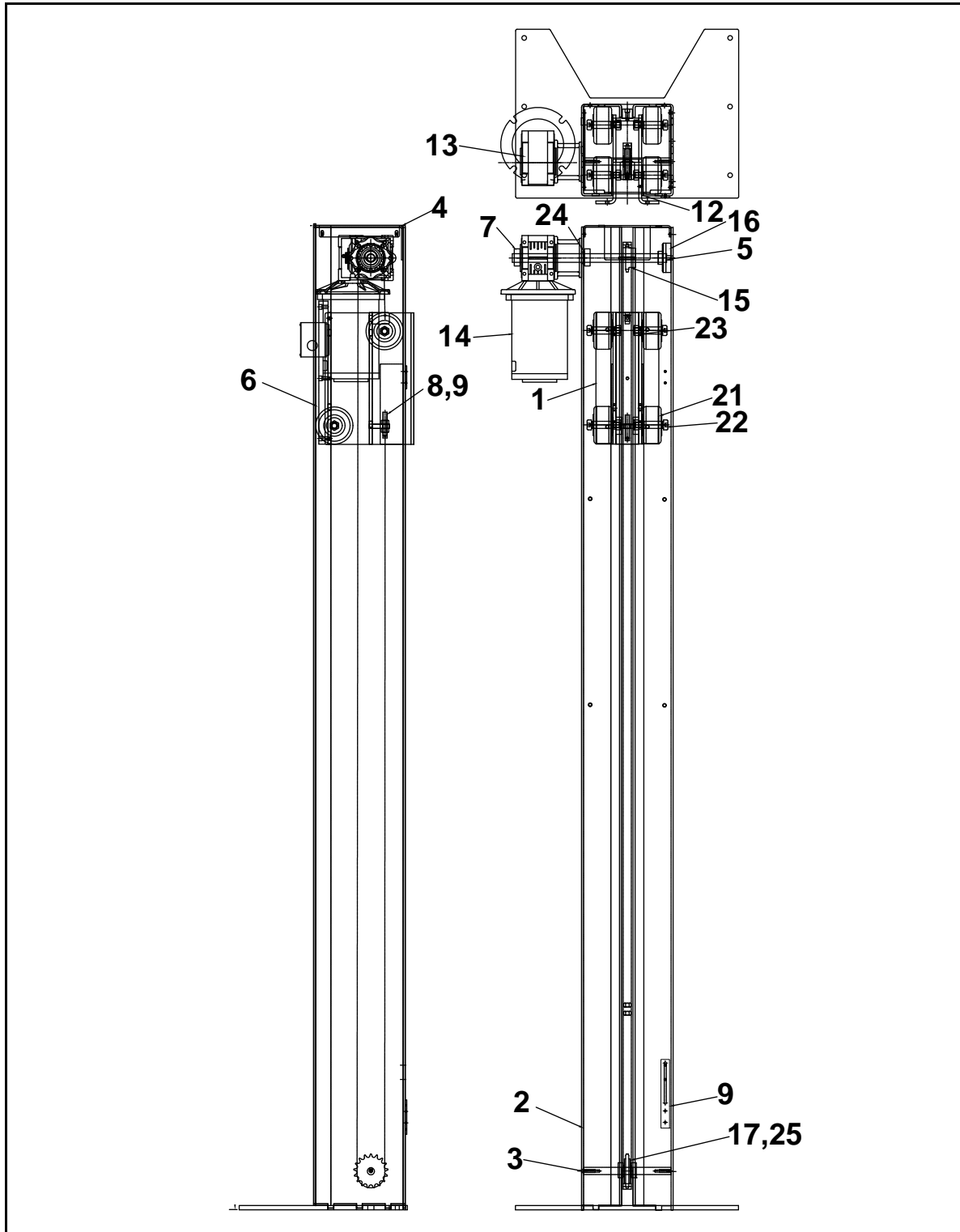

Figure 11-2. EZ/Pro Top Drive Tower Assembly

| Fig ref. | Part number | Description | Qty |
|----------|-------------|---|------|
| 1 | 229994. | Weldment, Carriage | 1 |
| 2 | 229988. | Weldment, Tower | 1 |
| 3 | 202169.002 | Shaft, 0.625", Tapped 1/4'-20, 7.640" Long | 1 |
| 4 | 229997. | Cover, Top | 1 |
| 5 | 229989. | Drive Shaft | 1 |
| 6 | 229634. | Plastic Guide | 1 |
| 7 | 800562. | Collar, Shaft, Set Screw, 3/4" | 2 |
| 8 | 204835. | Coupling, Chain Adjustment | 1 |
| 9 | 221607. | Bracket, Magnet, Tower, Right | 1 |
| 10 | 238493. | Plate, Cover, Plexiglass | 1 |
| 11 | 823638. | Flange, Extended Output Gearbox | 1 |
| 12 | 230030. | Tape, Slit | 2 |
| 13 | 821786. | Gearbox, Worm | 1 |
| 14 | 823673. | Motor, 1/3 H.P. | 1 |
| 15 | 821168. | Sprocket | 1 |
| 16 | 802744. | Bearing, Flange | 1 |
| 17 | 800906. | Sprocket | 1 |
| 18 | 823533. | Chain, Roller #40, 312 Pitches 156" | 1 |
| 19 | 800502. | Link, #40 | 1 |
| 20 | 804994.913 | Connector, Strain Relief | 1 |
| 21 | 820234. | Wheel, Caster | 4 |
| 22 | 800325.016 | Bolt, Shoulder, 5/8" Dia. X 1 3/4" | 4 |
| 23 | 820598. | Nut, Hex, 1/2"-13, Nylon Jam | 4 |
| 24 | 807258. | Washer, Oilite | 1 |
| 25 | 800560 | Collar, Shaft, Set Screw, 5/8" | 2 |
| 26 | 822425 | Tape, Double Sided, 3/4" | .07" |
| 27 | 800275.071 | Washer, Flat 5/8" X 1 1/4" X 14 ga. | 4 |

Table 11-3: Top Drive Tower Assembly

11.6 Side Mounted Film Saver Assembly

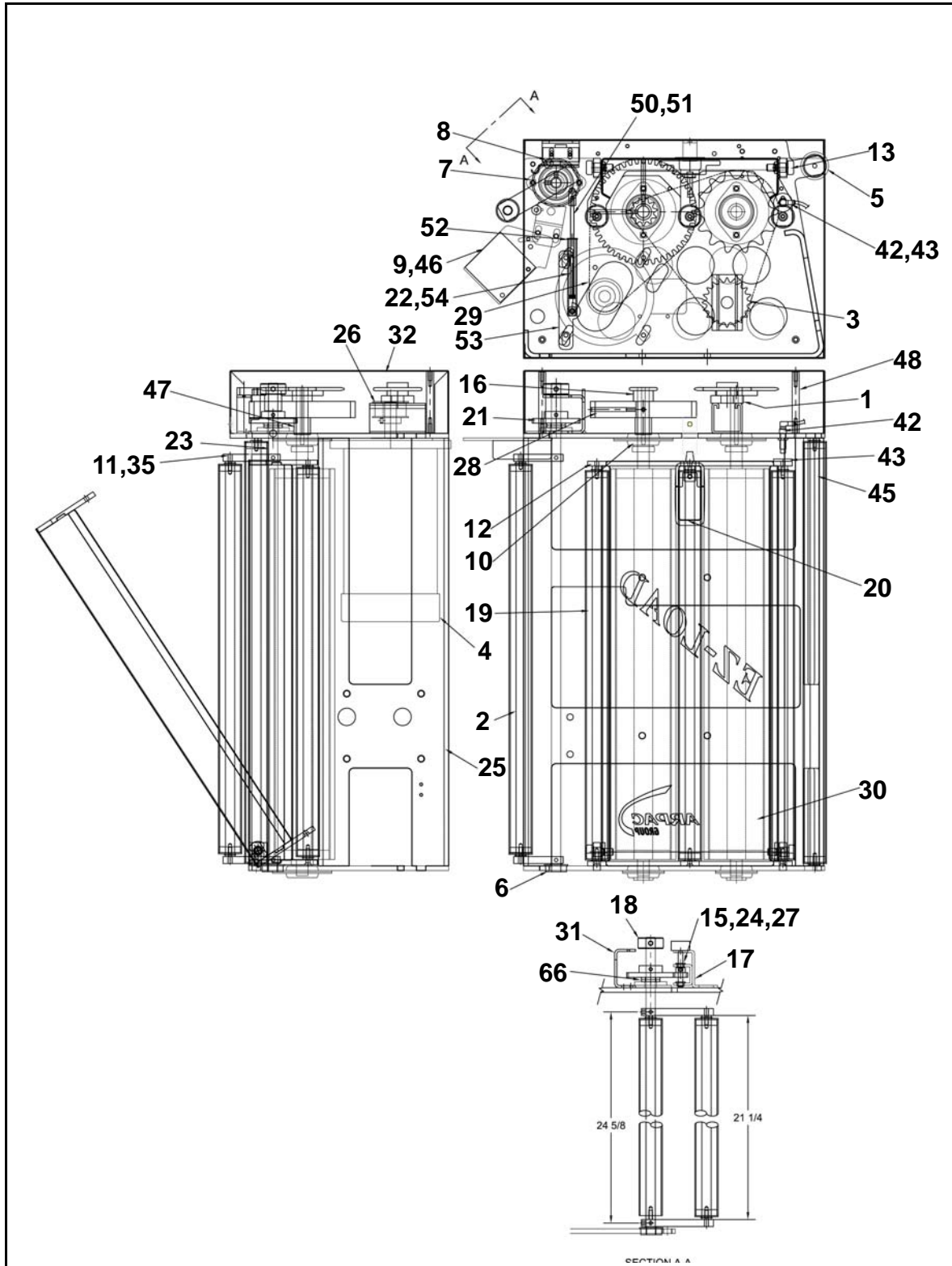

Figure 11-3. EZ/Pro Side Mounted Film Saver Assembly

| Fig ref. | Part number | Description | Qty |
|----------|-------------|-------------------------------------|-----|
| 1 | 224978. | Spacer, Idler Sprocket | 1 |
| 2 | 224903. | Shaft, Roller | 4 |
| 3 | 800912. | Sprocket | 1 |
| 4 | 823674. | Motor, 1/2 H.P. | 1 |
| 5 | 214611.003A | Roller Assembly | 1 |
| 6 | 820115. | Bearing Flange Rad | 1 |
| 7 | 821470. | Bearing Flange | 1 |
| 8 | 101412. | Stop Lever, Transfer Rack Film | 2 |
| 9 | 804007.165 | Photo Sensor | 1 |
| 10 | 820086. | Bearing Flange Black | 4 |
| 11 | 224913. | Plate, Dancer Bar | 2 |
| 12 | 224856. | Weldment, Roller Cage, 20" Film | 1 |
| 13 | 800324.003 | Bolt, Shoulder, 1/2 Dia. X 1/2" Lng | 2 |
| 14 | 241144. | Motor Mounting Ring Spacer | 1 |
| 15 | 820126. | Bushing, Oilite | 2 |
| 16 | 821152 | Sprocket | 1 |
| 17 | 214477 | Weldment, Pot Mounting Bracket | 1 |
| 18 | 800561 | Collar, Shaft Set Screw | 1 |
| 19 | 214611.002A | Roller Assembly | 5 |
| 20 | 822924. | Latch, Lift & Turn Compression | 1 |
| 21 | 218352 | Gear, Spur | 1 |
| 22 | 825104. | Spring, Compression | 1 |
| 23 | 211969.000A | Shaft, Dancer | 1 |
| 24 | 804998.351 | Pot, 10K Ohm | 1 |
| 25 | 224866 | Weldment, Film Saver Frame | 1 |
| 26 | 821477 | Pulley, Timing | 1 |
| 27 | 820827 | Gear, Spur | 1 |
| 28 | 230209 | Pulley, Timing | 1 |
| 29 | 823049 | Belt, Timing | 1 |
| 30 | 211973.000C | Weldment, Final, Roller | 2 |
| 31 | 214480. | Bracket, Microswtch Mounting | 1 |
| 32 | 224905.001 | Guard, Film Saver, Right Hand | 1 |
| 33 | 804998.553 | Switch-Limit | 1 |
| 34 | 800292.019 | Washer, Lock Split 5/8" | 1 |
| 35 | 800317.010 | Pin, Roll 3/16" Dia X 1 Lg | 2 |
| 37 | 800275.065 | Washer, #8 Flat | 2 |

Table 11-4: EZ/Pro Side Mounted Film Saver Assembly (1 of 2)

| Fig ref. | Part number | Description | Qty |
|----------|-------------|-----------------------------------|-----|
| 38 | 800328.006 | Socket Head Screw 1/4"-20 X 3/4" | 1 |
| 39 | 800341.005 | Screw, Set, 10-32 X 1/2" | 2 |
| 40 | 800328.013 | Socket Head Screw 1/4"-20 X 1 1/4 | 1 |
| 41 | 800325.003 | Shoulder Bolt | 1 |
| 42 | 804006.121 | Proximity Sensor | 1 |
| 43 | 822976. | Magnet | .5" |
| 44 | 800267.003 | Flat Head Screw 1/4-20 X 1/2 SS | 2 |
| 45 | 224903.001 | Roller Shaft | 1 |
| 46 | 224955. | Plate, Mounting | 1 |
| 47 | 224977. | Spacer, Pulley | 1 |
| 48 | 229619 | Spacer, Mounting Cover | 1 |
| 49 | 800292.005 | Washer, 1/4" Split Lock | 10 |
| 50 | 800246.040 | Socket Head Screw 10-32 X 5.5" | 1 |
| 51 | 237929. | Clevis, Spring | 1 |
| 52 | 237928 | Retainer, Spring | 1 |
| 53 | 237930.001 | Weldment, Spring Mounting Bracket | 1 |
| 54 | 825143. | Bushing, Oilite | 3 |
| 55 | 800322.003 | Shoulder Bolt, 5/16" X 5/8" Lg | 1 |
| 56 | 800321.002 | Shoulder Bolt, 1/4" X 3/8" Lg | 1 |
| 57 | 815213. | Washer, Oilite | 2 |
| 58 | 811314. | Washer, Oilite | 2 |
| 59 | 800292.012 | Washer, 3/8" Split Lock | 8 |
| 60 | 817011.002 | Washer, 5/16" External Lock | 1 |
| 61 | 800238.009 | Binder Head Screw, 10-32 X 1 1/2" | 1 |
| 62 | 800238.005 | Binder Head Screw, 10-32 X 3/4" | 4 |
| 63 | 800282.012 | Hex Head Bolt, 3/8"-16 X 1 1/4" | 4 |
| 64 | 800282.006 | Hex Head Bolt, 3/8"-16 X 3/4" | 4 |
| 65 | 800278.011 | Hex Head Bolt, 1/4"-20 X 1/2" | 10 |
| 66 | 800275.023 | Washer, Flat 1/2" Hardened | 2 |
| 67 | 800292.001 | Washer, #10 Split Lock | 9 |
| 68 | 800290.006 | Nut, Hex 1/4"-20 | 1 |
| 69 | 800307.003 | Screw, Pan Head, 6-32" X 1" | 2 |
| 70 | 800238.002 | Binder Head Screw, 10-32 X 3/8" | 5 |

Table 11-5: EZ/Pro Side Mounted Film Saver Assembly (2 of 2)

11.7 Swift Change Film Support Roll Assembly

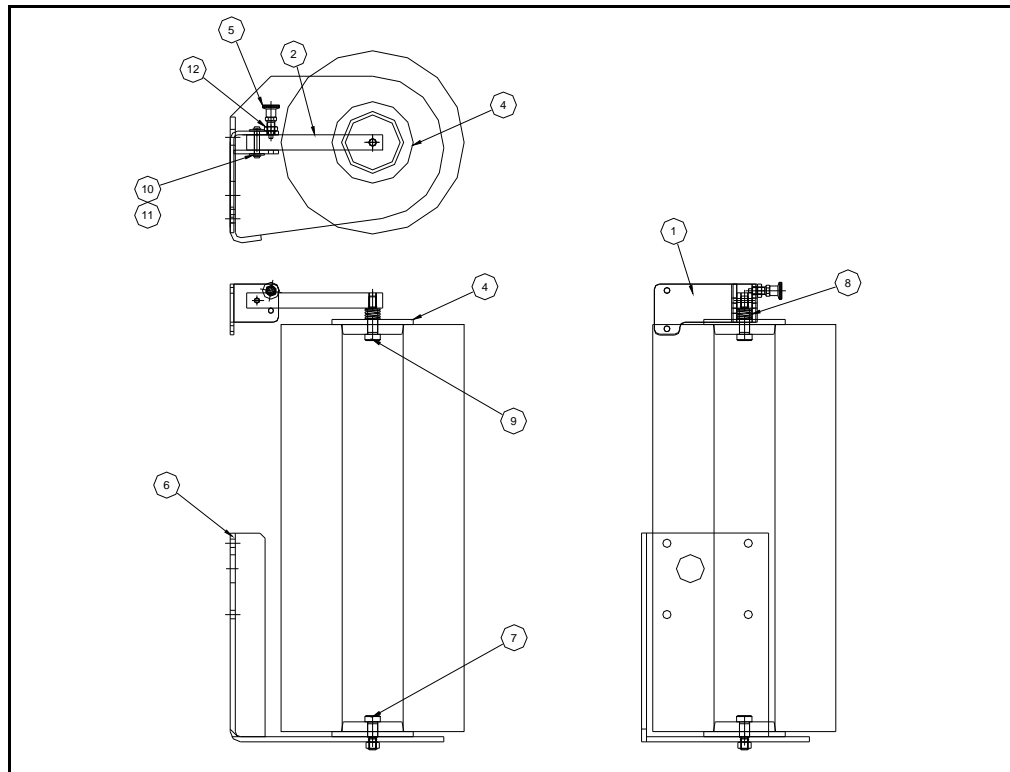

Figure 11-4. Swift Change Film Support Roll Assembly

| Fig ref. | Part number | Description | Qty |
|----------|-------------|--------------------------------------|-----|
| 1 | 255663 | Film Roll Top Clamp Weldment | 1 |
| 2 | 259626.001 | Film Support Arm | 1 |
| 4 | 224617 | Thrust Bearing | 2 |
| 5 | 810565 | Plunger, Index | 1 |
| 6 | 214497.002 | Film Holder Weldment | 1 |
| 7 | 800324.007 | Bolt, Shoulder, 1/2" Dia X 3/4" Long | 1 |
| 8 | 801031 | Spring, Compression | 1 |
| 9 | 800324.10 | Bolt, Shoulder, 1/2" Dia. X 1 1/4" | 1 |
| 10 | 838905 | Clevis Pin 1/4" OD X 1 1/4 Long | 2 |
| 11 | 800275.004 | Flat Washer 1/4" | 4 |
| 12 | 823229 | Nut, Hex, Jam 3/8" - 24 | 1 |

Table 11-6: Swift Change Film Support Roll Assembly

11.8 Base Assembly (4000lb Capacity, 59.5" Dia)

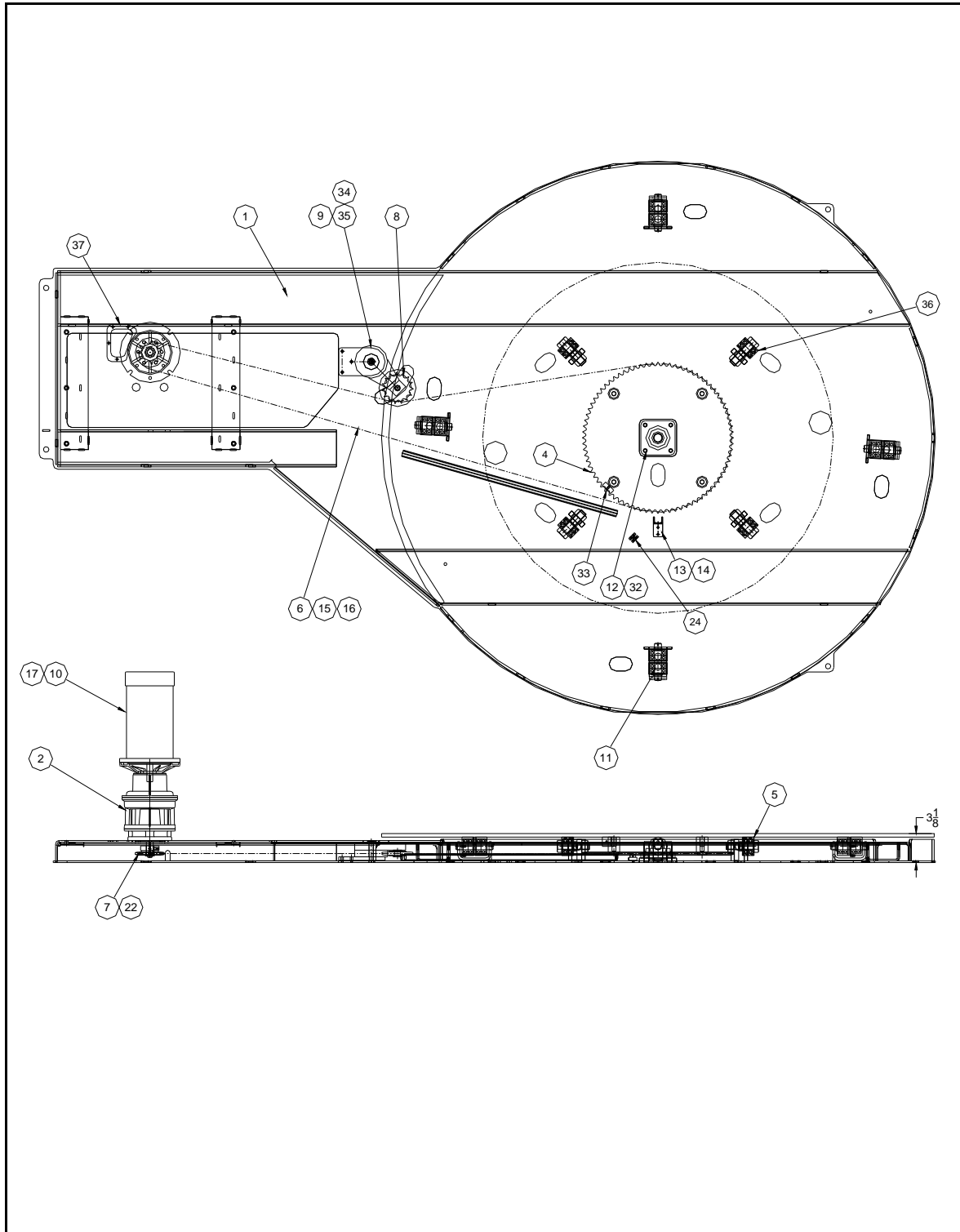

Figure 11-5. Base Assembly (4000lb Capacity, 59.5" Dia)

| Fig ref. | Part number | Description | Qty |
|----------|-------------|--|-----|
| 1 | 252949 | Weldment Base | 1 |
| 2 | 823639 | Gearbox | 1 |
| 4 | 234814 | Weldment, Drive Sprocket | 1 |
| 5 | 229964 | Turntable, 59.5" Dia | 1 |
| 6 | 823617 | Chain, Roller, #50 225 Pitches, 140.625" lg | 1 |
| 7 | 823678 | Sprocket | 1 |
| 8 | 800905 | Sprocket | 1 |
| 9 | 224963 | Plate, Mounting, Take Up | 1 |
| 10 | 823674 | Motor, 1/2 H.P. | 1 |
| 11 | 205939 | Roller Assembly | 4 |
| 12 | 820091 | Bearing, Flange, 1" ID, 4 Bolt | 1 |
| 13 | 224967 | Mounting Bracket, Prox Switch, LP | 1 |
| 14 | 804006.121 | Proximity Sensor | 1 |
| 15 | 800505 | Link, #50 | 1 |
| 16 | 800522 | Link, #50 Offset | 1 |
| 17 | 804011.104 | Cord Connector | 1 |
| 22 | 810778-004 | Fender Washer, 1/4" X 1" | 1 |
| 24 | 804998.703 | Terminal Strip | 1 |
| 32 | 802207 | Grease Fitting, 90 Degree | 1 |
| 33 | 822976 | Magnet, Rect, 3/16 X 3/4" X 2" | 1 |
| 34 | 822957 | Shoulder Bolt, 7/16-20 X 2 | 1 |
| 35 | 807279 | Spring Tensioner | 1 |
| 36 | 252948 | Roller Assembly | 4 |
| 37 | 253182 | Cover Plate, Chain | 1 |

Table 11-7: Base Assembly Wrap & Weigh Option

11.9 Base Assembly - Wrap & Weigh Option

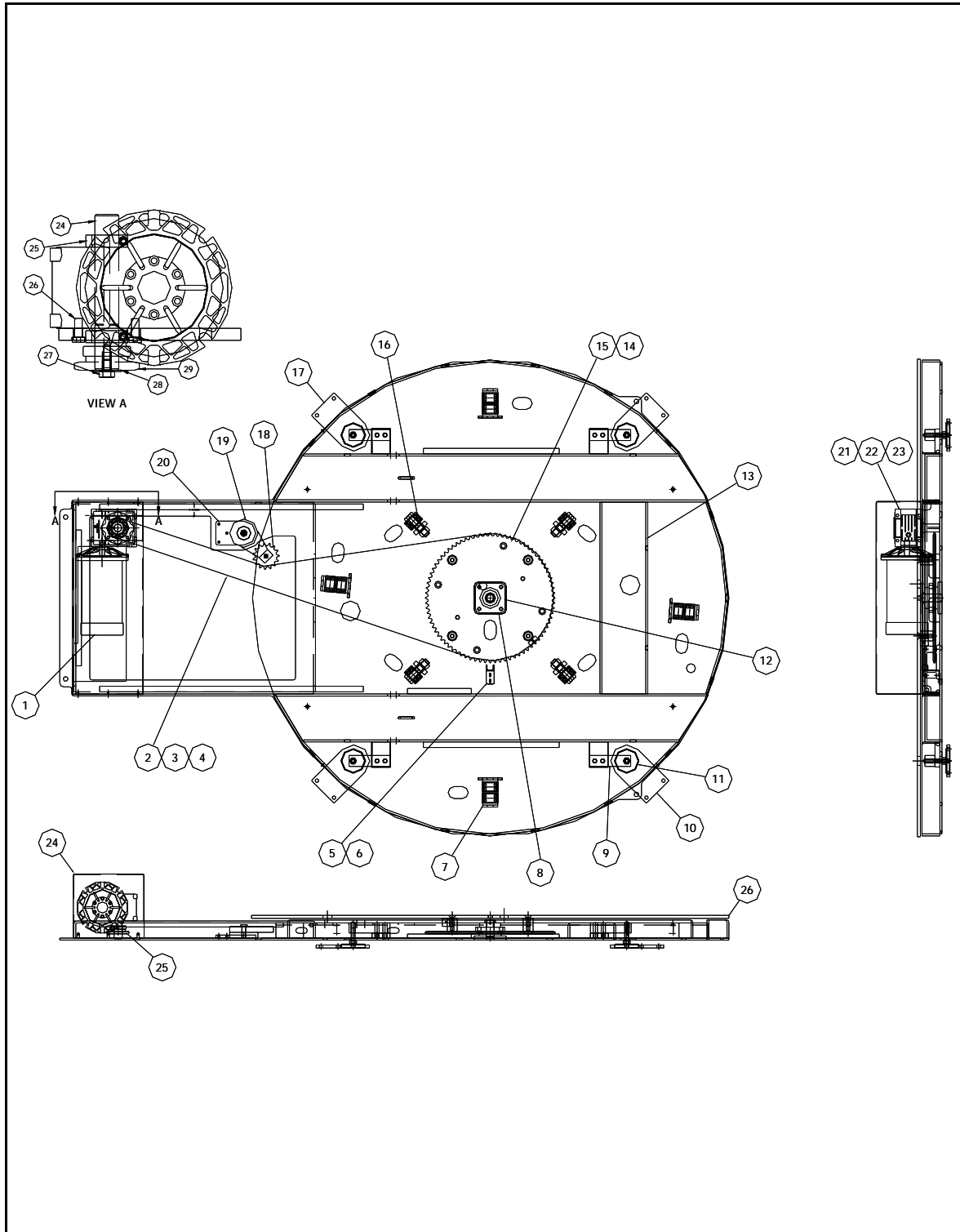

Figure 11-6. Base Assembly (4000lb Capacity, 59.5" Dia)

| Fig ref. | Part number | Description | Qty |
|----------|-------------|---|-----|
| 1 | 823674 | Motor, 1/2 H.P. | 1 |
| 2 | 823617 | Chain, Roller, #50 225 Pitches, 140.625" lg | 1 |
| 3 | 800505 | Link, #50 | 1 |
| 4 | 800522 | Link, #50 Offset | 1 |
| 5 | 804006.121 | Proximity Sensor | 1 |
| 6 | 224967 | Bracket, Mounting, Proximity Switch | 1 |
| 7 | 205939 | Roller Assembly | 4 |
| 8 | 820091 | Flange Bearing | 1 |
| 9 | 207386 | Spacer, Scale Beam | 4 |
| 10 | 823674 | Motor, 1/2 H.P. | 4 |
| 11 | 207387.000A | Scale Pedestal Weldment | 4 |
| 12 | 802207 | Grease Fitting, 90Deg, 1/4-28 Tapered | 1 |
| 13 | 252032 | Weldment Base, WNW & Split | 1 |
| 14 | 822976 | Magnet, Rect, 3/16 X 3/4" X 2" | 1 |
| 15 | 234814 | Weldment, Drive Sprocket | 1 |
| 16 | 252948 | Roller Assembly | 4 |
| 17 | 237442 | Kit Parts Base, Wrap & Weigh | 1 |
| 18 | 800905 | Sprocket | 1 |
| 19 | 807279 | Spring Tensioner | 1 |
| 20 | 224963 | Plate, Mounting, Take Up | 1 |
| 21 | 821002 | Gearbox, Worm | 1 |
| 22 | 252034 | Cover, Motor | 1 |
| 23 | 229964 | Turntable, 59.5" Dia | 1 |
| 24 | 251224 | Shaft, Gearbox, 1" Dia | 1 |
| 25 | 800600 | Collar, Shaft, Clamp | 2 |
| 26 | 823045.001 | Shoulder Bolt, M8 X 20MM | 4 |
| 27 | 800282.002 | Cap Screw, 3/8"-16 X 1/2" | 1 |
| 28 | 810778.003 | Fender Washer, 3/8" X 1 1/4" | 1 |
| 29 | 821194 | Sprocket 1" ID | 1 |
| | 804996.936 | Panel, Enclosure. 8" X 6" | 1 |
| | 804997.804 | Enclosure, Electrical | 1 |
| | 804998.503 | Load Cell, Pennsylvania Scale, 4K | 4 |

Table 11-8: Base Assembly (4000lb Capacity, 59.5" Dia)

11.10 Tower Base Assembly - Wrap & Weigh

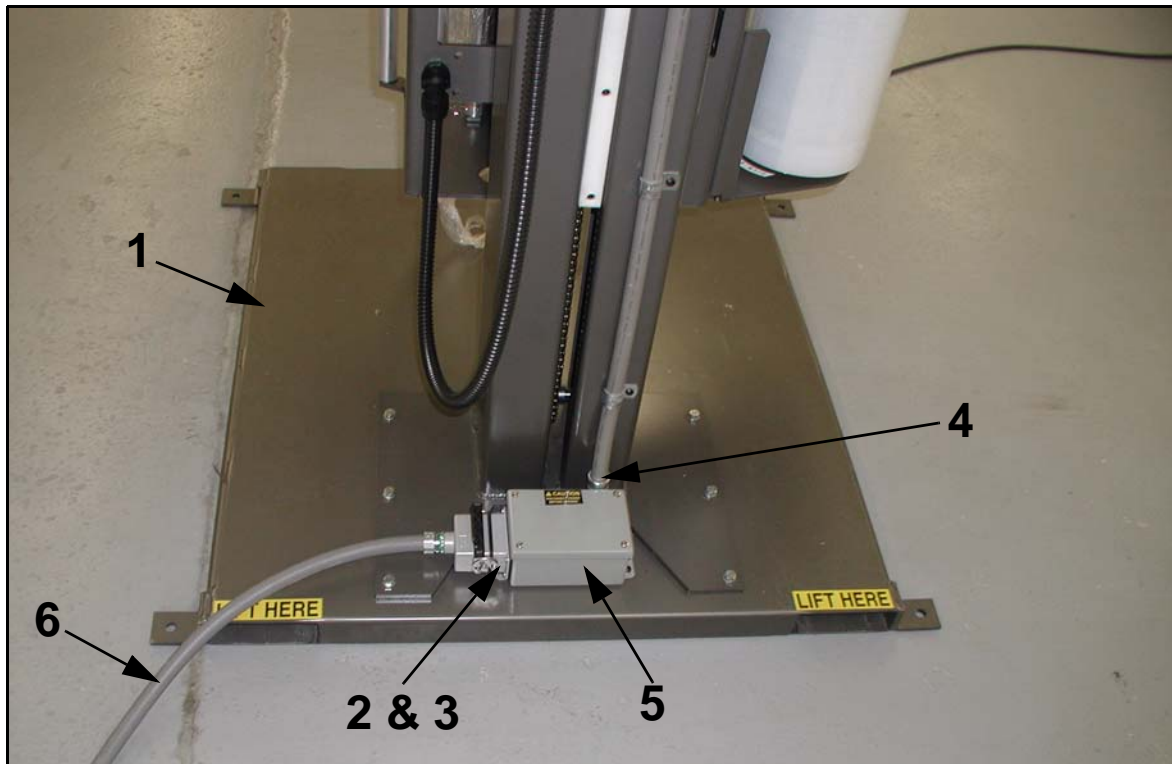

Figure 11-7. Tower Base Assembly - Wrap & Weigh

| Fig ref. | Part number | Description | Qty |
|----------|-------------|--|-----|
| 1 | 229668 | Weldment, Split Frame Tower Base | 1 |
| 2 | 825005.056 | Connector, 10P, Insert, Female 16A | 1 |
| 3 | 825005.053 | Connector, Base, PNL Mount Single Lock | 1 |
| 4 | 804011.104 | Conduit, Connector , 0.375" 90 Deg | 1 |
| 5 | 804014.125 | Enclosure | 1 |
| 6 | 237441 | Base to Tower Cable Assembly | 1 |

Table 11-9: Tower Base Assembly - Wrap & Weigh

Page Intentionally Blank

11.11 Control Assembly (Part 1)

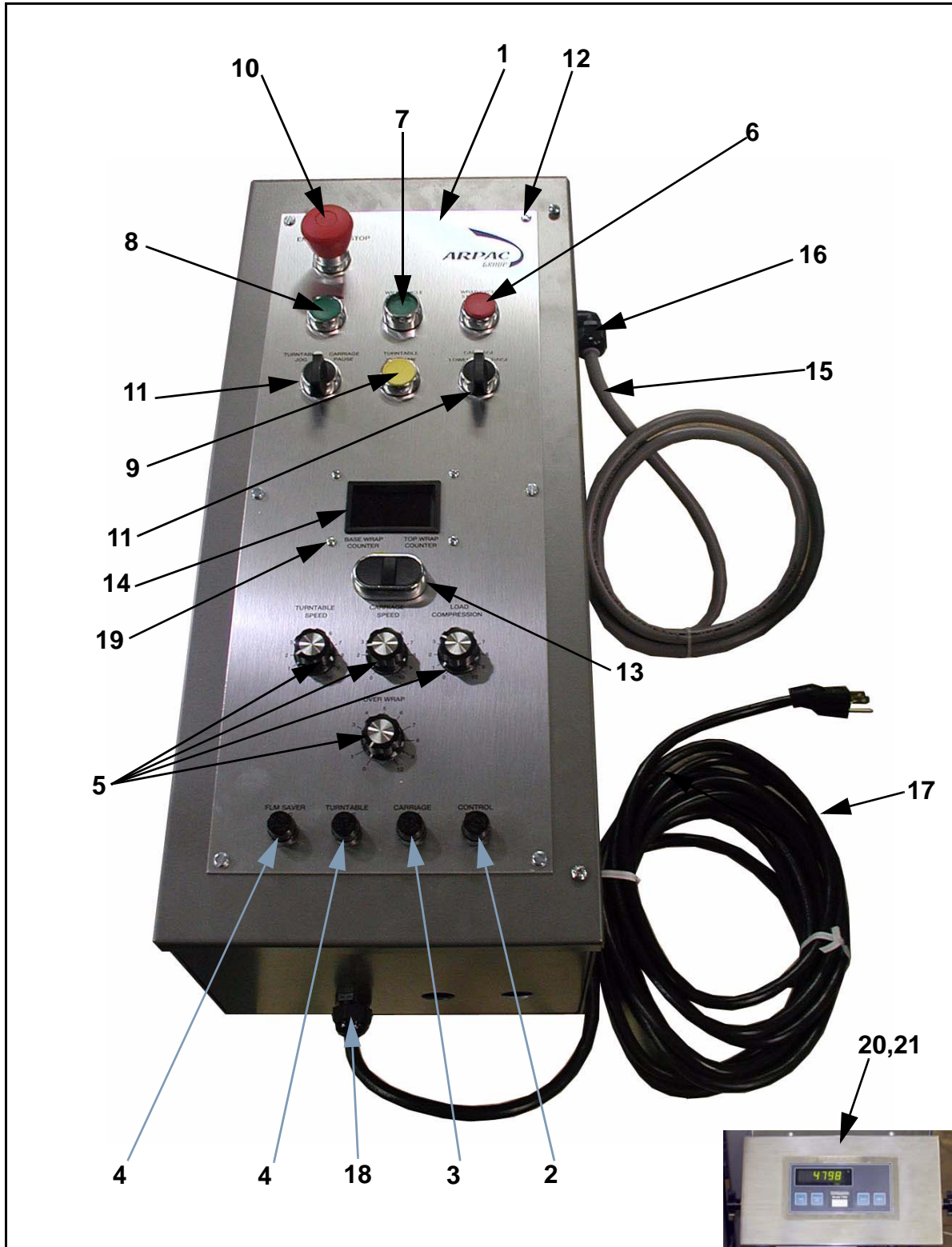

Figure 11-8. Control Assembly (Part 1)

| Fig ref. | Part number | Description | Qty |
|----------|-------------|---------------------------------------|-----|
| 1 | 235212. | Cover, Control Panel | 1 |
| 2 | 804998.226 | Fuse, Glass AGC, 2 Amp 250VAC | 1 |
| 3 | 804998.231 | Fuse, Glass AGC, 8 Amp 250VAC | 1 |
| 4 | 804998.233 | Fuse, Glass, AGC, 10 Amp 250VAC | 2 |
| 5 | 804998.313 | Knob | 4 |
| 6 | 804004.170 | Push Button, Red | 1 |
| 7 | 804004.173 | Push Button, Green | 1 |
| 8 | 804004.168 | Push Button, Green | 1 |
| 9 | 804004.172 | Push Button, Yellow | 1 |
| 10 | 804004.175 | Push Button, Mushroom Head | 1 |
| 11 | 804021.031 | Selector Switch | 2 |
| 12 | 800308.007 | Screw, Pan Head, 8-32 X 1" | 6 |
| 13 | 804004.176 | Pushbutton, 2 Position | 1 |
| 14 | 820864 | Lens - Bezel & Filter | 1 |
| 15 | 804003.150 | Cable, 18 AWG, 3 Cond w Gnd | 1 |
| 16 | 804010.179 | Connector, 90 Degree, Strain Relief | 1 |
| 17 | 205905 | Power Cord Assembly | 1 |
| 18 | 804010.178 | Connector, Strain Relief | 1 |
| 19 | 800312.002 | Screw, Pan Head Phillips, 6-32 X 3/8" | 4 |
| 20 | 821096 | Trim Board - Pennsylvania Scale | 1 |
| 21 | 821093 | Digital Readout - Pennsylvania Scale | 1 |

Table 11-10: Control Assembly (Part 1)

11.12 Control Assembly (Part 2)

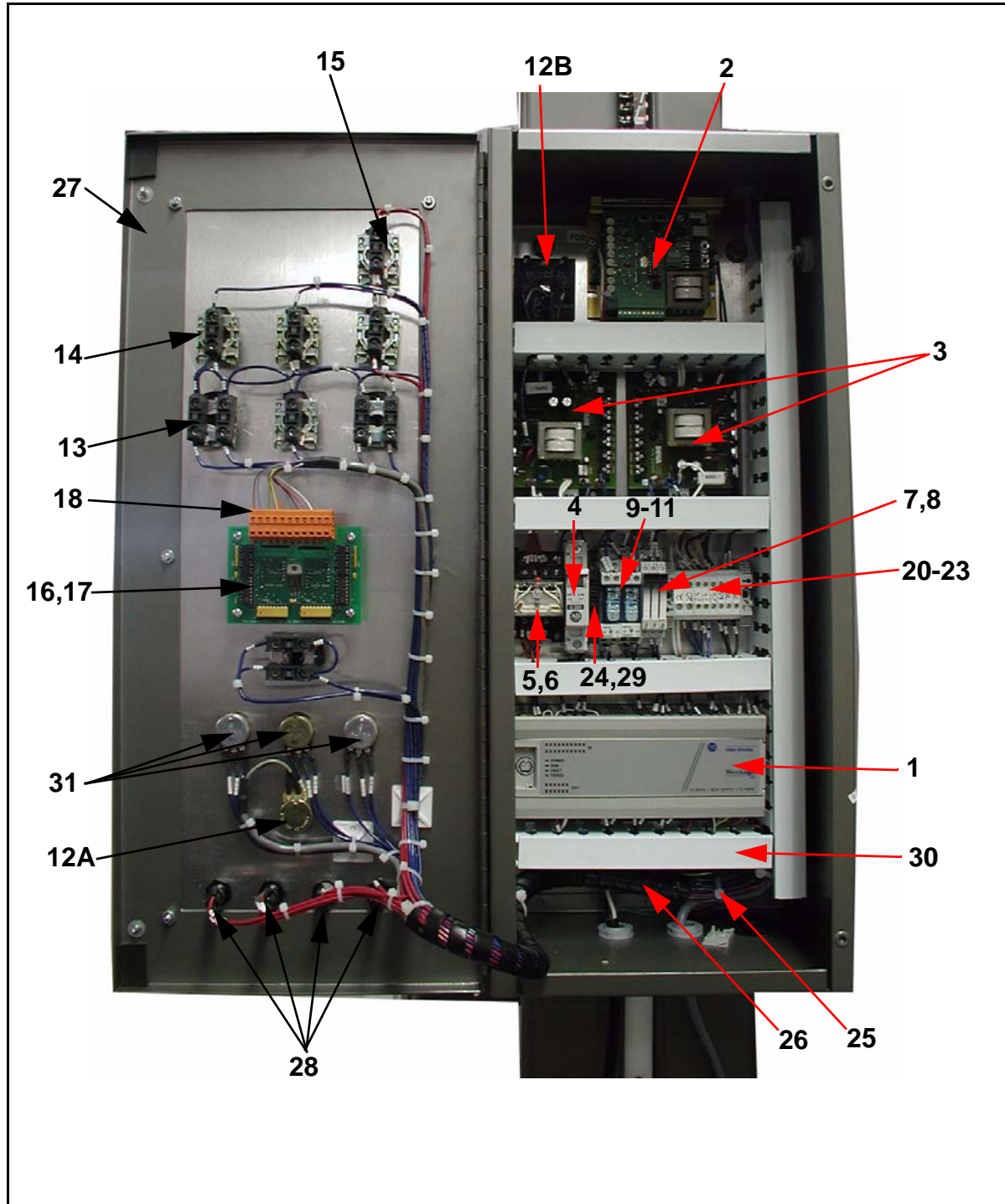

Figure 11-9. Control Assembly (Part 2)

| Fig ref. | Part number | Description | Qty |
|-----------|-------------|-------------------------------------|-----|
| 1 | 804005.284 | PLC, MLX 1000 | 1 |
| 2 | 804012.182 | Drive, Regenrative 1/4-1HP | 1 |
| 3 | 804012.190 | Drive, DC, 1/4 HP 90 VDC | 2 |
| 4 | 804000.011 | Circuit Breaker, 20 Amp | 1 |
| 5 | 804008.087 | Relay, 4 Pole, 10A, 120VAC | 1 |
| 6 | 804008.088 | Relay Socket for 4 Pole Relay | 1 |
| 7 | 804008.089 | Relay, 1 Pole 6A, 24VDC | 3 |
| 8 | 804008.112 | Relay Jumper, Extra Slim Blue | 1 |
| 9 | 804008.105 | Relay, 2 Pole, 8A, 24VDC DPDT | 2 |
| 10 | 804008.116 | Relay, Diode | 2 |
| 11 | 804008.103 | Relay, Socket, 8 Blade for 2 Pole | 2 |
| 12A & 12B | 804008.101 | Relay, Time Off Delay Kit | 1 |
| 13 | 804004.180 | Push Button Latch | 8 |
| 14 | 804004.177 | Push Button Contacts, 22mm 1NO/0/NC | 9 |
| 15 | 804004.178 | Push Button Contacts, 22mm 0NO/1/NC | 2 |
| 16 | 211650 | Counter Display | 1 |
| 17 | 804998.517 | Nylon Spacer | 4 |
| 18 | 804998.025 | Connector | 1 |
| 19 | 804008.098 | Relay Marker | 1 |
| 20 | 804022.013 | Terminal Block | 9 |
| 21 | 804022.033 | Terminal Block, End Anchor | 2 |
| 22 | 804022.062 | Terminal Block, End Barrier | 1 |
| 23 | 804022.091 | Terminal Block, Jumper Strip | 1 |
| 24 | 804022.029 | Terminal Block, High Density | 1 |
| 25 | 804010.087 | Connector, Burndy | 1 |
| 26 | 235213 | Plate, Electrical Panel | 1 |
| 27 | 229880 | Electrical Enclosure | 1 |
| 28 | 804998.241 | Fuse Holder | 4 |
| 29 | 804015.150 | Fuse, 0.25A 250V Fast Acting Glass | 1 |
| 30 | 804039.002 | Wire Duct | 4 |
| 31 | 804998.350 | Pot-10K Ohm, Single Short Stem | 1 |

Table 11-11: Control Assembly (Part 2)

